

Ganci a gambo grezzo tipo GNIC / GNIA

GNIC / GNIA type rough shank hooks

Tipo GNIC
Acciaio al carbonio
Tipo GNIA
Acciaio legato

GNIC Type
Carbon steel
GNIA Type
Alloy steel

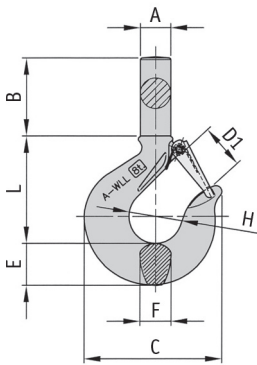

| Codice Code | Portata WLL | Codice Code | Portata WLL | Dimensioni Dimensions | | | | | | | | Peso Weight | |
|----------------|----------------|----------------|----------------|--------------------------|---------|---------|----------|---------|---------|---------|---------|----------------|--|
| | | | | A mm | B mm | C mm | D1 mm | E mm | F mm | H mm | L mm | | |
| GNIC | t | GNIA | t | | | | | | | | | | |
| AGNIC0,8 | 0,8 | AGNIA1,25 | 1,25 | 15 | 49 | 77 | 20 | 21 | 15 | 31 | 59 | 0,35 | |
| AGNIC1 | 1 | AGNIA1,6 | 1,6 | 17 | 57 | 82 | 22 | 23 | 18 | 34 | 67 | 0,55 | |
| AGNIC1,6 | 1,6 | AGNIA2,5 | 2,5 | 19 | 64 | 94 | 23 | 27 | 23 | 38 | 73 | 0,78 | |
| AGNIC2 | 2 | AGNIA3,2 | 3,2 | 23 | 69 | 106 | 27 | 31 | 24 | 42 | 82 | 1,10 | |
| AGNIC3,2 | 3,2 | AGNIA5,4 | 5,4 | 29 | 81 | 132 | 35 | 37 | 29 | 50 | 101 | 2,00 | |
| AGNIC5 | 5 | AGNIA8 | 8 | 36 | 92 | 165 | 43 | 49 | 37 | 62 | 126 | 3,80 | |
| AGNIC7,5 | 7,5 | AGNIA11,5 | 11,5 | 43 | 101 | 198 | 53 | 60 | 43 | 75 | 157 | 7,00 | |
| AGNIC10 | 10 | AGNIA16 | 16 | 48 | 112 | 222 | 58 | 67 | 52 | 84 | 167 | 10,50 | |
| AGNIC15 | 15 | AGNIA22 | 22 | 59 | 135 | 283 | 78 | 80 | 64 | 110 | 210 | 18,50 | |
| - | - | AGNIA31,5 | 31,5 | 85 | 244 | 339 | 87 | 94 | 80 | 120 | 250 | 37,50 | |

- Tipo **GNIC** coefficiente di sicurezza 5.
- Tipo **GNIA** coefficiente di sicurezza 4.
- **GNIC** type safety factor 5.
- **GNIA** type safety factor 4.

