

Kit sicurezze tipo 2DS (tipo pesante)

2DS heavy type safety latches

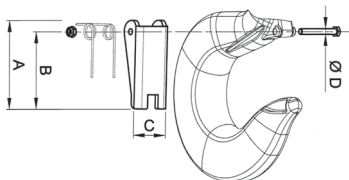

Codice Code	Marcatura Marking	Portata ganci Hooks WLL	Portata ganci Hooks WLL	Dimensioni Dimensions			
		GNOG-GNSC-GNIC t	GOA-GNSA-GNIA t	A mm	B mm	C mm	D mm
2DS0D1	D1	0,8	1,25	39,5	32,5	17	4
2DS0D2	D2	1	1,6	43,5	35,5	23	4
2DS0D3	D3	1,6 - 2	2,5 - 3,2	49	41	25	5
2DS0D4	D4	3,2	5,4	61,5	51,5	29	5
2DS0D5	D5	5	8	77,5	67,5	35	6
2DS0D6	D6	7,5	11,5	87	76	37	6
2DS0D7	D7	10	16	96	85,5	49	6
2DS0D8	D8	15	22	131	116	54	6
2DS0D9	D9	20	30	152,5	135	64	8

Kit sicurezze tipo ST3 (tipo pesante)

ST3 heavy type safety latches

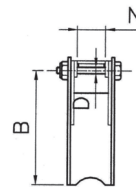

Codice Code	Marcatura Marking	Portata ganci Hooks WLL	Portata ganci Hooks WLL	Dimensioni Dimensions		
		GNOG-GNSC-GNIC t	GOA-GNSA-GNIA t	B mm	D mm	N mm
AST301	ST301	0,8	1,25	34	4	7,4
AST301	ST301	1	1,6	34	4	7,4
AST303	ST303	1,6	2,5	39	4	11,1
AST304	ST304	2	3,2	41	4	11,1
AST305	ST305	3,2	5,4	50	4	11,1
AST306	ST306	5	8	68	6	16,2
AST307	ST307	7,5	11,5	75	6	17,7
AST308	ST308	10	16	84	6	23
AST309	ST309	15	22	115	6	23

Kit sicurezze tipo ST2 (tipo leggero)

ST2 light type safety latches

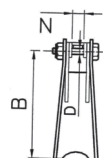

Codice Code	Marcatura Marking	Portata ganci Hooks WLL	Portata ganci Hooks WLL	Portata ganci Hooks WLL	Portata ganci Hooks WLL	Dimensioni Dimensions		
		GNOG-GNSC-GNIC t	GOA-GNSA-GNIA t	G1-G2 kg	UNI 4395 kg	B mm	D mm	N mm
AST201	ST201	0,8	1,25			32	4	7,9
AST202	ST202	1	1,6			36	4	7,9
AST203	ST203	1,6	2,5			40	4	6
AST204	ST204	2	3,2	100		45	4	6
AST205	ST205				0,8	49	4	7
AST206	ST206	3,2	5,4	150 - 200		53	4	8
AST207	ST207				1	60	5	11,1
AST208	ST208	5	8		1,6	70	5	11,1
AST209	ST209			350	2	75	6	11,1
AST212	ST212	7,5	11,5	500	2,5	81	6	16,7
AST213	ST213	10	16	650 - 800	3,2 - 4 - 5	90	6	16,7
AST215	ST215	20	30	1000 - 1500		134	6	24

Sicurezze tipo pesante per ganci DIN

Heavy type latches for DIN hooks

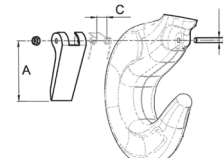

Codice Code	Per gancio grandezza For hook size		Dimensioni Dimensions		
	DIN 15401	DIN 15402	A mm	C mm	D mm
2DS002	012	-	35,5	10	M4
2DS003	025	-	41	11	M4
2DS004	05	-	51,5	13	M5
2DS005	08+1	-	67,5	13	M5
2DS0A6	-	2,5	81	17	M6
2DS006	1,6+2,5	-	75	17	M6
2DS007	4	4	84	20	M6
2DIN05	5	6	96	20	M10
2DIN06	6	8	106	20	M10
2DIN08	8	10	122	25	M12
2DIN10	10	12	132	25	M12
2DIN12	12	16	150	30	M16
1DIN16	16	20	170	35	M16
1DIN21	20	25	198	40	M16
1DIN26	25	32	212	40	M16
1DIN33	32	40	236	50	M20
1DIN41	40	50	265	54	M20
1DIN51	50	63	300	54	M24
1DIN64	63	80	335	54	M24
1DIN83	80	100	375	54	M24
1DIN84	100	125	425	54	M30

Kit sicurezze a caduta per ganci tipo UNI 4395

UNI 4395 hook safety latches

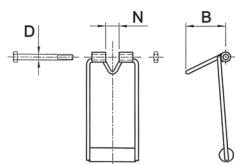

Codice Code	Marcatura Marking	Portata WLL	Dimensioni Dimensions		
		t	B mm	D mm	N mm
ASC202	SC202	1	50	5	11
ASC203	SC203	1,6	70	5	11
ASC203L	SC203L	2	75	6	14
ASC204	SC204	2,5	80	6	18
ASC205	SC205	3,2 - 4 - 5	100	6	16