

### CARATTERISTICHE SPECIFICATION

Vacuum lifters for marble and stones powered with compressed air, with 0-90° pneumatically operated tilting.

- 0-90° pneumatic overturning of the supporting frame, with provision for locking in the horizontal position;
- Air pressure 6/7 bar;
- Safety large aluminium tank of vacuum to grant the grip of the marble even in the absence of current; the tank is equipped with a tap to drain the condense;
- Acoustic and visual alarm to advise a low level of vacuum; the alarm is powered by rechargeable batteries;
- A battery charger at 230V single phase is supplied as well;
- Central handle with slide valve to grip and release the load.

**Ventose per il marmo funzionanti ad aria compressa con ribaltamento 0-90° pneumatico.**

- Ventosa a vuoto continuo, funzionante con pompa ad aria compressa;
- Struttura portante con ribaltamento 0-90° pneumatico;
- Pressione di esercizio 6/7 Bar;
- Serbatoio di pre-vuoto per garantire la presa anche in caso di mancanza di aria compressa;
- Sistema di allarme acustico e visivo per la segnalazione di un abbassamento del vuoto alimentato da batterie ricaricabili;
- Carica batterie alimentato a 230V monofase;
- Vacuometro di controllo presa materiale;
- Manico centrale per l'operatore con comandi per la presa e il rilascio del materiale.

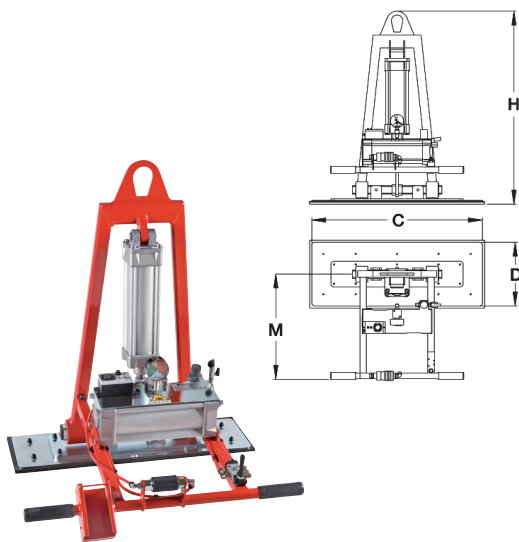

### DATI TECNICI - 1 PIASTRA TECHNICAL DATA - 1 SUCTION PAD

Portata WLL	Tipo Type	Piastre Suction pads	Dimensioni piastre Suction pads dimensions	Dimensioni Dimensions	Consumo aria Air consumption	Peso Weight	
Kg		n°	CxD mm	M mm	l/min	kg	H mm
80	FM1R-80	1	400x150	400	130	30	880
100	FM1R-100	1	400x200	400	130	30	880
125	FM1R-125	1	500x200	400	130	31	880
200	FM1R-200	1	600x200	400	130	32	880
250	FM1R-250/5	1	500x300	400	130	34	880
250	FM1R-250/7	1	700x200	400	130	38	880
300	FM1R-300/6	1	600x300	400	130	39	880
300	FM1R-300/8	1	800x200	400	130	40	880
500	FM1R-500/5	1	550x400	450	130	62	900
500	FM1R-500/8	1	800x300	450	130	62	900
1000	FM1R-1000	1	1000x450	500	270	85	900

### DATI TECNICI - 2 PIASTRE TECHNICAL DATA - 2 SUCTION PADS

Portata WLL	Tipo Type	Piastre Suction pads	Dimensioni piastre Suction pads dimensions	Dimensioni Dimensions				Consumo aria Air consumption	Peso Weight	H mm
				A mm	B min/max mm	G min/max mm	M mm			
Kg		n°	CxD mm					l/min	kg	
250	FM2R-250	2	200x500	1410	800/1800	690/840	590	130	60	850
500	FM2R-500	2	300x500	1420	920/1800	740/840	590	130	81	890
1000	FM2R-1000	2	400x550	1460	1070/1880	790/865	590	270	101	900

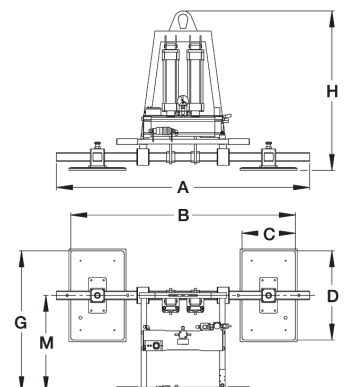
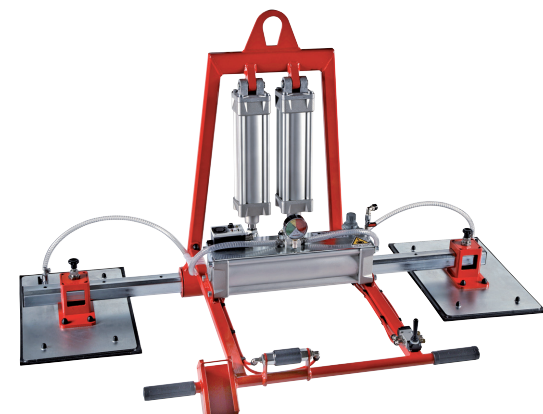

**DATI TECNICI - 3 PIASTRE**  
TECHNICAL DATA - 3 SUCTION PADS

Portata WLL	Tipo Type	Piastre Suction pads	Dimensioni piastre Suction pads dimensions		Dimensioni Dimensions				Consumo aria Air consumption	Peso Weight	H mm
			Laterali Lateral	Centrali Central	A mm	B min/max mm	G min/max mm	M			
Kg		n°	CxD mm	ExF mm					l/min	kg	
375	FM3R-375	3	200x500	200x500	1410	800/1800	690/840	590	130	65	850
625	FM3R-625	3	300x500	200x500	1420	920/1800	740/840	590	130	87	890
1125	FM3R-1125	3	400x550	200x500	1460	1070/1880	790/865	590	270	105	900

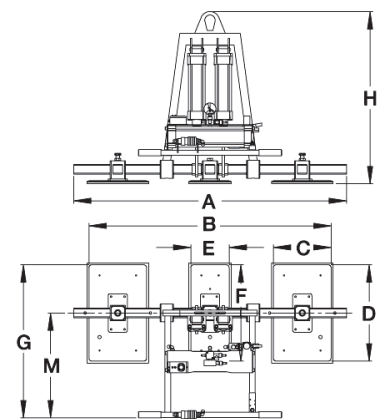
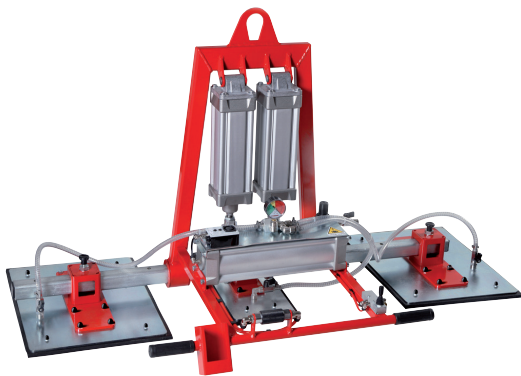

**DATI TECNICI - 4 PIASTRE**  
TECHNICAL DATA - 4 SUCTION PADS

Portata WLL	Tipo Type	Piastre Suction pads	Dimensioni piastre Suction pads dimensions		Dimensioni Dimensions					Consumo aria Air consumption	Peso Weight	H mm
			CxD mm	A mm	B min/max mm	G min/max mm	Q min/max mm	P mm	M mm			
Kg		n°								l/min	kg	
500	FM4R-500	4	500x200	1420	820/1800	830/1200	470/1230	840	590	130	86	860
1000	FM4R-1000	4	500x300	1460	970/1830	930/1200	670/1230	840	590	270	88	900
2000	FM4R-1500	4	550x400	1460	1030/1885	1030/1240	870/1290	870	590	270	108	1080

